

NEW
from ARI!



**100%
GUARANTEED**

We serve only top engineering with high quality products to make your business to be success .

PRODUCTS

We supply only top quality brand .

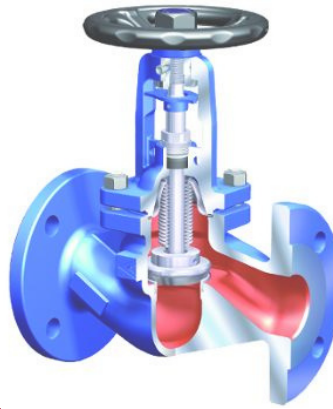

WHAT YOU CAN GET FROM US !

Correct sizing and selection for your system design and utilization with full supports of global engineering knowledgable technicians .



PHONE

+95 9 262 707 732



ADDRESS

Sales Office :
Q-3 ,
Thiri Yadanar
Wholesale Market
Thudhamar Road ,
Yangon
Myanmar.

SYSTEM ANCILLARY



EMAIL

admin@myansteam.com



WEB

myansteam.com

MYAN STEAM

Steam & Fluid Expert !



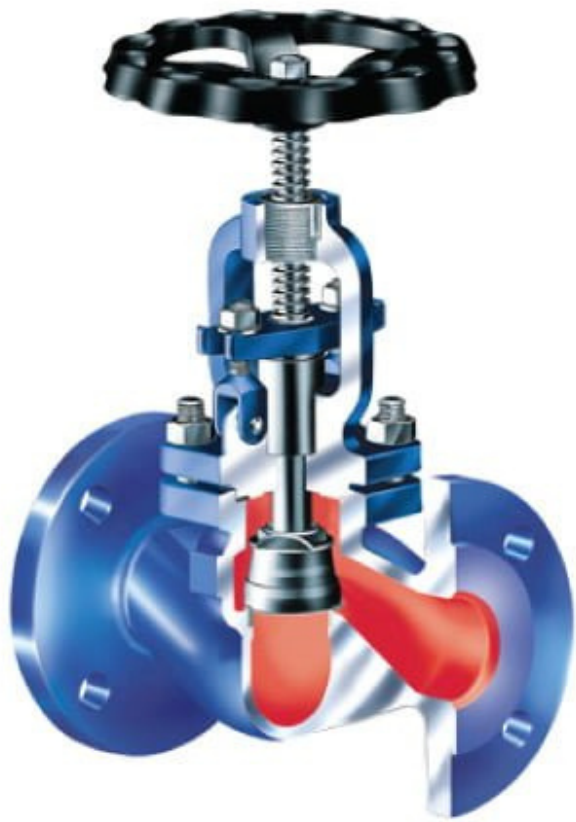

GLAND SEAL VALVE

- Application: Industrial installations, hospitals, food and beverages, processing technology, vapour facilities, plant manufacturing
- Medium: Process water, aggressive media, etc.
- Size : DN 15 to DN 500 (1/2" to 20")



HIGH TEMP GLOBE VALVE

- Application: Industrial installations, hospitals, food and beverages, processing technology, vapour facilities, plant manufacturing
- Medium: Process water, aggressive media, etc.
- Size : DN 10 to DN 150 (1/4" to 6")

BUTTER - FLY VALVE

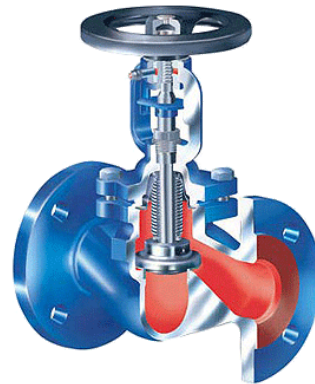

BELLO SEAL VALVE

BLOWDOWN STOP VALVE

Blow down valve - straight through with flanges and pneumatic actuator.

- Application : steam boiler engineering
- Medium : Cooling water, cooling brine, warm water, hot water, steam, gas, etc.

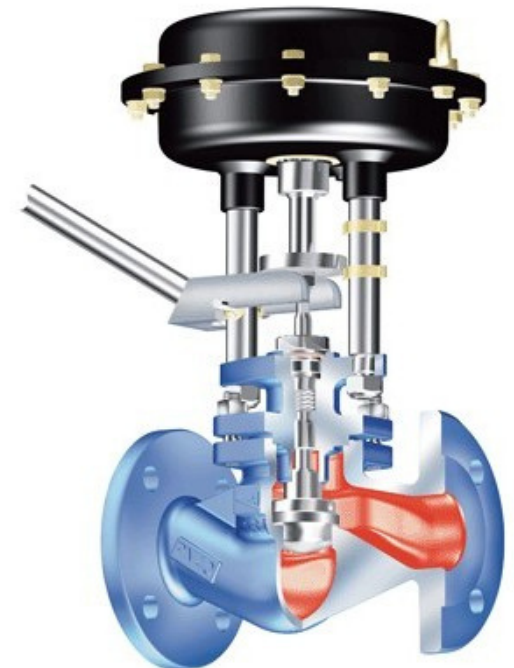

SAFETY & RELIF VALVE

Full lift/Standard safety valve with flanges - closed bonnet - closed lifting device - acc. to VdTÜV sheet 100, AD2000-A2 and EN ISO 4126-1
Application medium : Steam, aggressive gases, vapours and liquids





TRIPLE OFF-SET VALVE

- Long and maintenance free service life due to the stellite seat.
- Rotary movement without wear or friction (seat and sealing ring) due to the optimised contact angles.
- Hardened stainless steel bearings.



PRESSURE REGULATING VALVE

Pressure regulating valve - straight through with flanges - spring loaded
Application media for Liquids, gas and vapour, steam.

PNEUMATIC PISTON VALVE

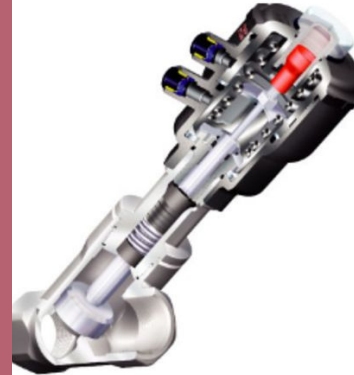

FLOW REGULATING VALVE

Combined flow regulating valve - straight through with flanges and special spindle seal
Application for Heating facilities, AIR conditioning facilities



PNEUMATIC BALL VALVE



SELF ACTING CONTROL

Thermal-closing valve - straight through with flanges without cooling spacer (max. 150°C).
Application for Industrial heating and ventilation systems, residential applications, marked-warehouses, ship building, cooling systems, etc.





PNEUMATIC CONTROL VALVES

ON-Off action valves are single seat, two-way body construction with in-line straight connection.

Application for water , superheated water , steam , air , gas and other fluids.



PNEUMATIC ANGLE VALVE

Pneumatic pilot solenoid valve with electro-mechanical switches

Application for steam , water , other fluid compatible with the flow consumption.

NON RETURN VALVE



CHECK VALVE

Recycling facilities, chemical industry, hospital technology, process water installations, installations with aggressive media



DISC CHECK VALVE

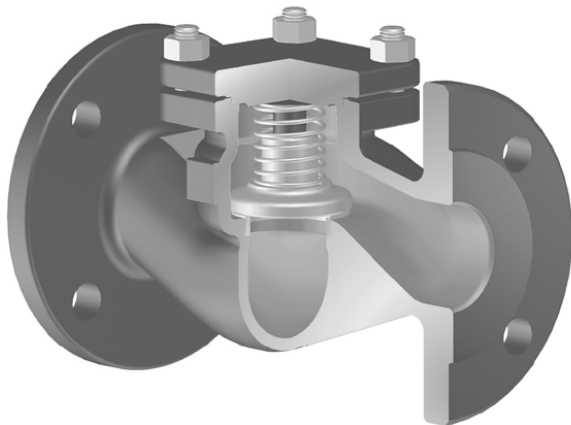

OVER FLOW VALVE

Overflow (by-pass) valves are single seated two-way body constructed with in-line straight connection.

Application for Heat transfer oil and other fluids compatible with the construction.



PIPE LINE Y STRAINERS FLANGED

Strainers are applicable to all of steam , water , oil and air systems.

Connection with different PN rating of flanged.

Material : Stainless asteel , Forged Steel , Cast Steel , Nodular Iron



VACUUM

BRAKER



PRESURE GAUGE

Bourdon tube pressure gauges are the most common type in many areas and are used to measure medium to high pressures.

- Pressure Range : -1 to 1500 Bar
- Pressure display units : bar / mbar, kPa / MPa, PSI, kg/cm², mH2O, inH2O



SIGH GLASS

A sight glass is a device which allows a person to see the level of fluids or gases in a system.

Application : Condensate water , Feed water line and industrial fluid.

Type : Single , double window and sight checker.



AIR - VENT
FOR
WATER
SYSTEM

PIPE LINE Y STRAINERS

Strainer are applicable to all of steam , water , oil and air systems.

Connection with female screwed.





STEAM INJECTOR

Steam injectors use steam to raise the temperature of water or other liquids.

MECHANICAL PUMP

A pump is a device that moves fluids (high temperature liquids condensate), or sometimes slurries, by mechanical action, Typically converted from electrical energy into Hydraulic energy.

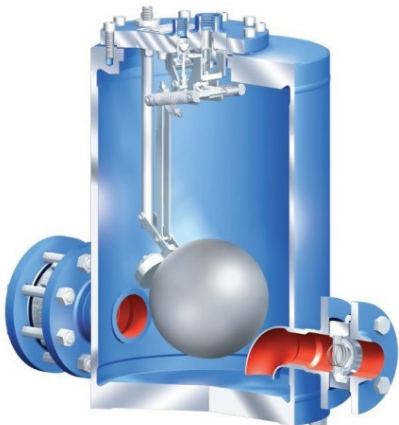

MECHANICAL PUMP TRAP

Mechanical Pumping Traps are used to drain condensate from process applications, when the steam pressure in the process application is not sufficient to push the condensate to the condensate return lines or to the condensate vessel.

BALL
VALVE



GLOBE
SEAL
VALVE



DIGITAL PRESSURE GAUGE

- Pressure Range - -1 to 1000 Bar
- 6 switchable pressure units
bar / mbar, kPa / MPa, PSI, kg/cm², mH₂O, inH₂O
- Options
- DAkkS certificate
 - SIKa works certificate

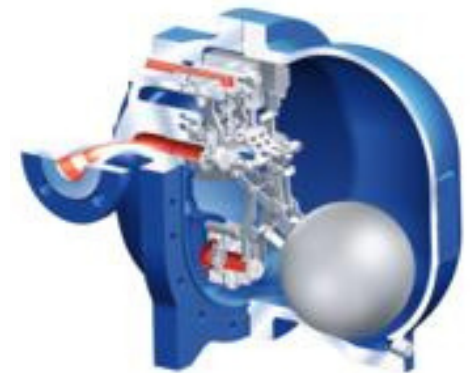



BOILER CROWN VALVE

A steam boiler must be fitted with a stop valve (also known as a crown valve) which isolates the steam boiler and its pressure from the process or plant. It is generally an angle pattern globe valve of the screw-down variety.

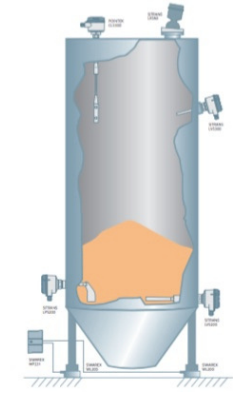
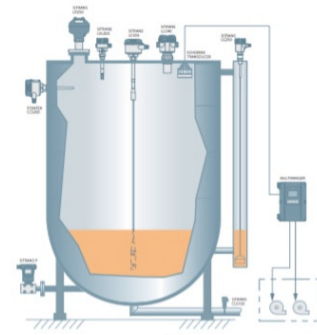

PNEUMATIC PISTON VALVE



LEVEL MEASUREMENT

Level sensors detect the level of liquids, other fluids and fluidized solids, including slurries, granular materials, and powders that exhibit an upper free surface.



FLOW REGULATOR

Combined flow regulating valve - straight through with flanges and special spindle seal
Application for Heating facilities, AIR conditioning facilities



PNEUMATIC BALL VALVE



SAMPLE COOLER

Thermal-closing valve - straight through with flanges without cooling spacer (max. 150°C).
Application for Industrial heating and ventilation systems, residential applications, marked-warehouses, ship building, cooling systems, etc.

PLATE HEAT EXCHANGER

High Efficient Energy Saving Plate Heat Exchanger for Industrial Heating and Cooling.

Material :

Plates : AISI 316, AISI 304, Titanium, C2000, and most alloys

Gaskets: NBR, EPDM, FKM, Paramine and other types



PIPE INSULATION

Pipe insulation can prevent condensation forming, as the surface temperature of the insulation will vary from the surface temperature of the pipe. Condensation will not occur.

Material : Stainless steel / Alu-zinc

MOISTURE

SEPARATOR



SHELL AND TUBE HEAT EXCHANGER

Steam to Liquid , Liquid to fluid heating & cooling process.

It is the most common type of heat exchanger in F&B , oil refineries and other large chemical processes, and is suited for higher-pressure applications.

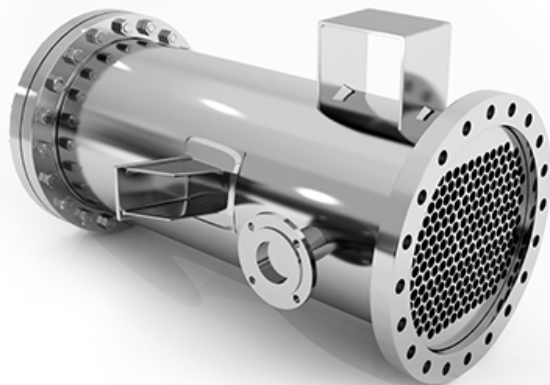

PIPE

SADDLE



MINERAL WOOL

Thermal insulation is the reduction of heat transfer (i.e., the transfer of thermal energy between objects of differing temperature) between objects in thermal contact or in range of radiative influence.



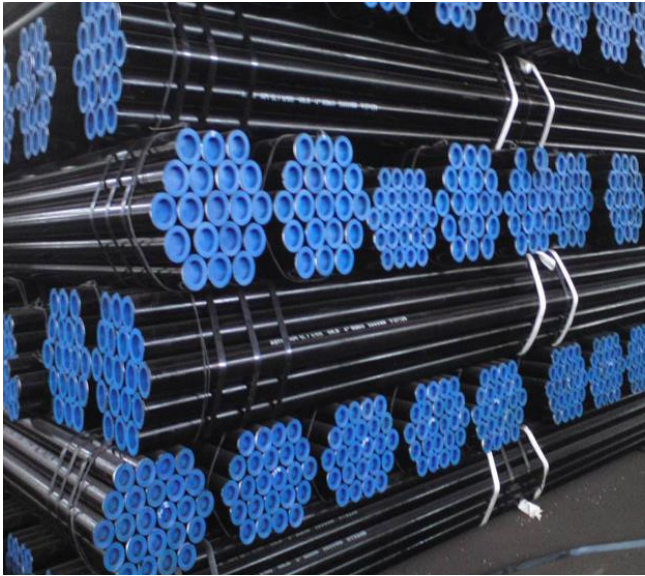

PIPE FOR HIGH HEAT AND PRESSURE

We supply stainless steel and Ni -based alloy pipes and tubes have superior corrosion resistance , heat resistance , and low-temperature properties. Products have been used as raw material that can withstand harsh environments as seen in petroleum refining , petroleum chemistry , power generation , etc.
Standards : ASTM / ASME , EN , JIS



GASKET MATERIAL

We supply with safety & corrosive protection high quality gasket materials. Material : PTFE , paper, rubber, silicone, metal, cork, felt, neoprene, nitrile rubber, fiberglass.

FLANGED AND FITTING

High quality fitting products for F & B , marine vessels , nuclear power plants , process plants , pulp and paper mills and offshore oil production.



H I G H
T E N S I O N
B O L T

EXPENSION BELLOW

Installed to compensate for thermal expansion, vibrations and misalignments.



MYAN STEAM

admin@myansteam.com

Sales Office :
Q-3 ,
Thiri Yadanar
Wholesale Market ,
Thudhamar Road ,
North Okklapa Tsp; ,
Yangon ,
Myanmar.

